



COMMUNITY ARTS CENTER

at the Buffalo Grove Park District

RENTAL OPTIONS





COMMUNITY ARTS CENTER

at the Buffalo Grove Park District

ROOM 6
1020 SF

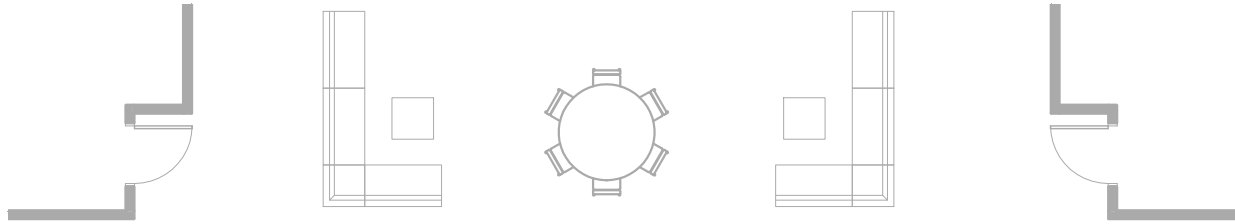

SAMPLE SET-UP

TABLES : 8

CHAIRS: 64

EQUIPMENT

NONE

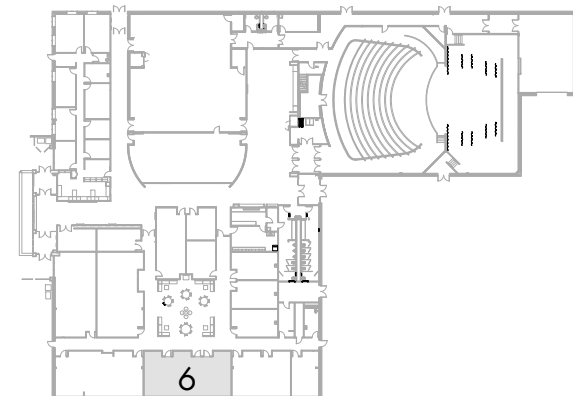
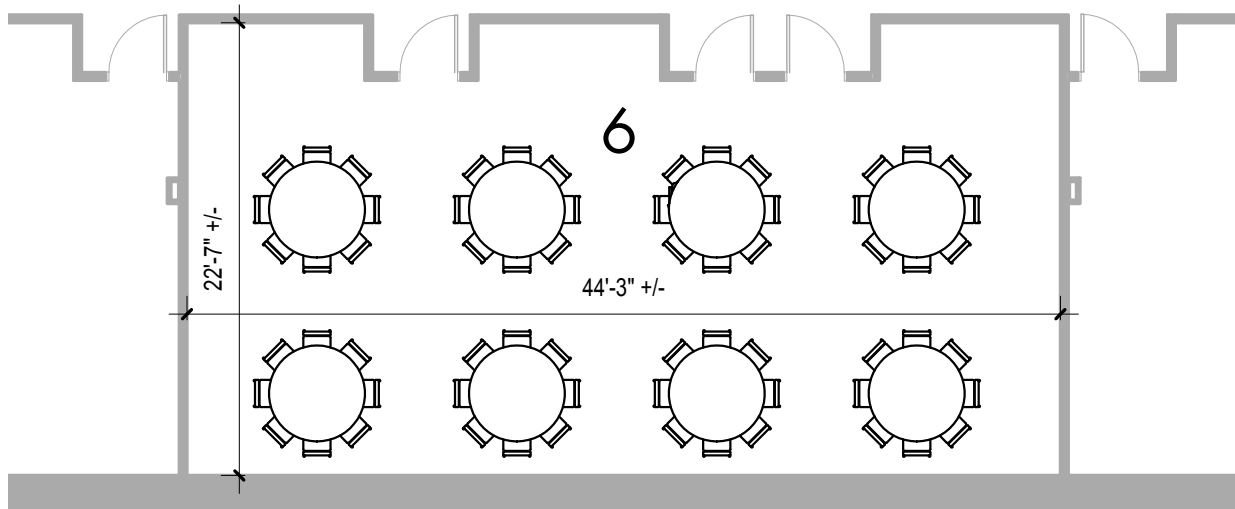

HOURLY ROOM RATES (MINIMUM OF 2 HOURS, HOLIDAYS BILLED AT A RATE OF TIME AND A HALF)

MONDAY-THURSDAY: RESIDENT = \$40 NON-RESIDENT = \$50

FRIDAY-SUNDAY: RESIDENT = \$50 NON-RESIDENT = \$65



COMMUNITY ARTS CENTER

at the Buffalo Grove Park District

ROOM 19
1435 SF

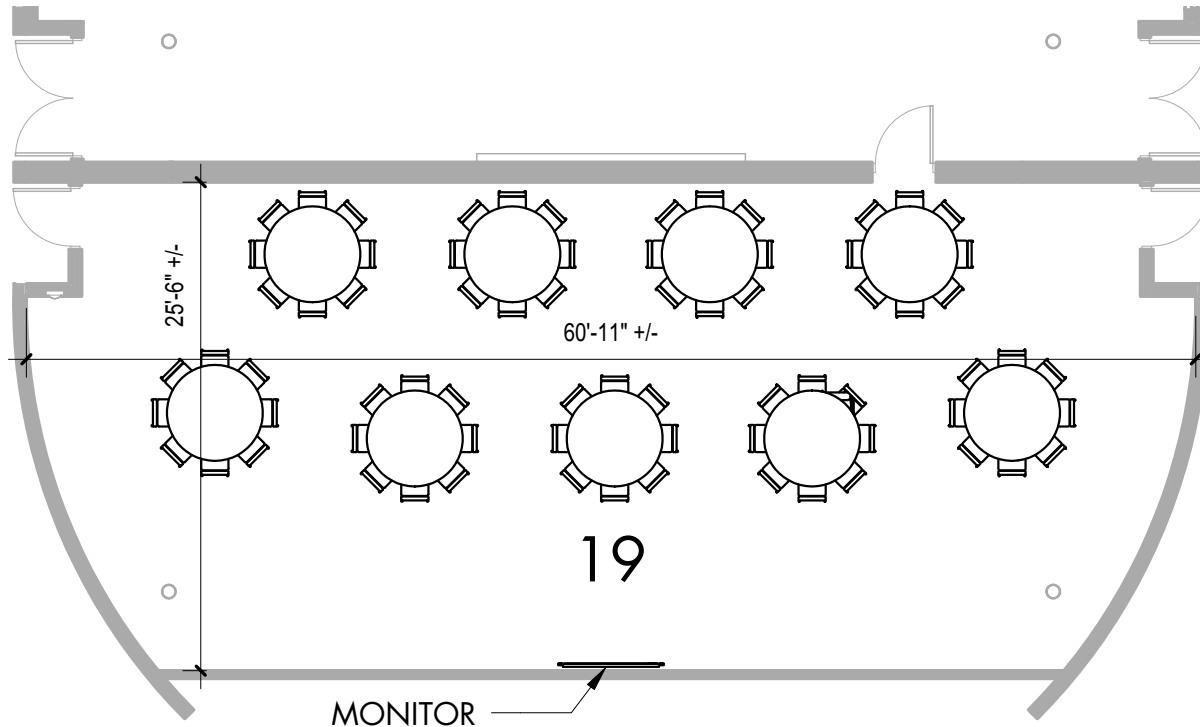

SAMPLE SET-UP
TABLES : 9
CHAIRS: 72

EQUIPMENT
MONITOR

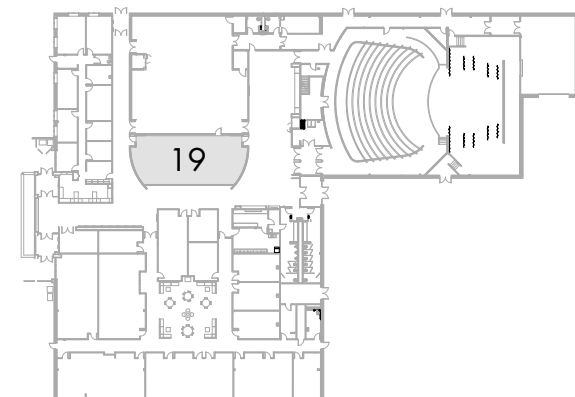

HOURLY ROOM RATES (MINIMUM OF 2 HOURS, HOLIDAYS BILLED AT A RATE OF TIME AND A HALF)

MONDAY-THURSDAY:	RESIDENT = \$75	NON-RESIDENT = \$95
FRIDAY-SUNDAY:	RESIDENT = \$95	NON-RESIDENT = \$120

WIRED MICROPHONE	\$15 PER RENTAL	(OPTIONAL)
------------------	-----------------	------------



COMMUNITY ARTS CENTER

at the Buffalo Grove Park District

ROOM 20
1980 SF

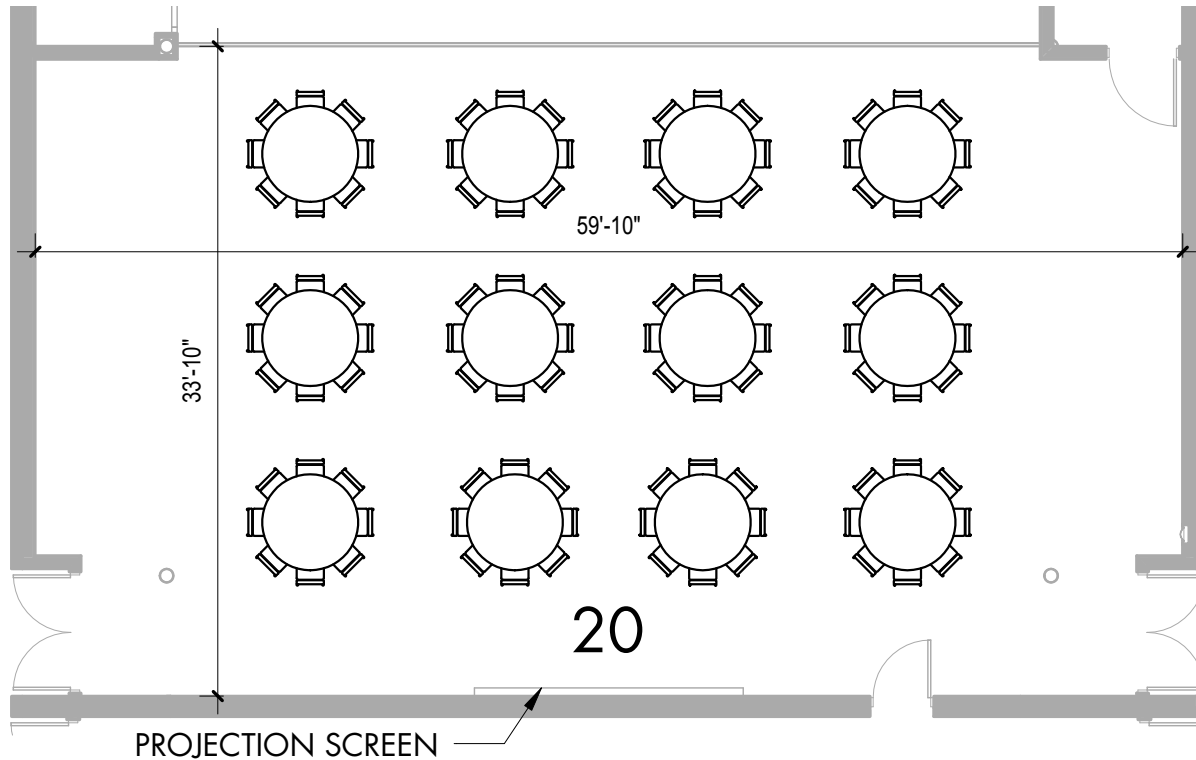

SAMPLE SET-UP

TABLES : 12

CHAIRS: 96

EQUIPMENT

PROJECTOR

SCREEN

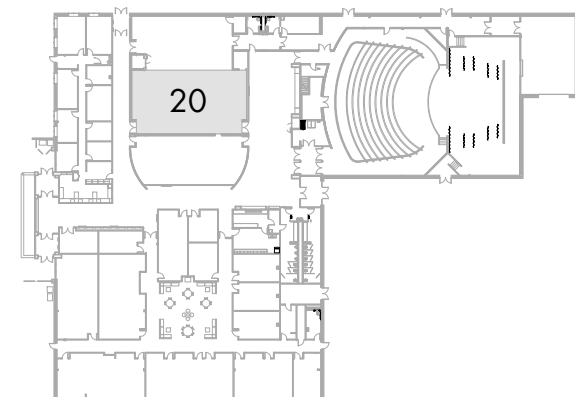

HOURLY ROOM RATES (MINIMUM OF 2 HOURS, HOLIDAYS BILLED AT A RATE OF TIME AND A HALF)

MONDAY-THURSDAY: RESIDENT = \$85 NON-RESIDENT = \$110

FRIDAY-SUNDAY: RESIDENT = \$110 NON-RESIDENT = \$140

PROJECTOR AND SCREEN \$150 PER RENTAL (OPTIONAL)

WIRED MICROPHONE \$15 PER RENTAL (OPTIONAL)



COMMUNITY ARTS CENTER

at the Buffalo Grove Park District

ROOM 21

1400 SF

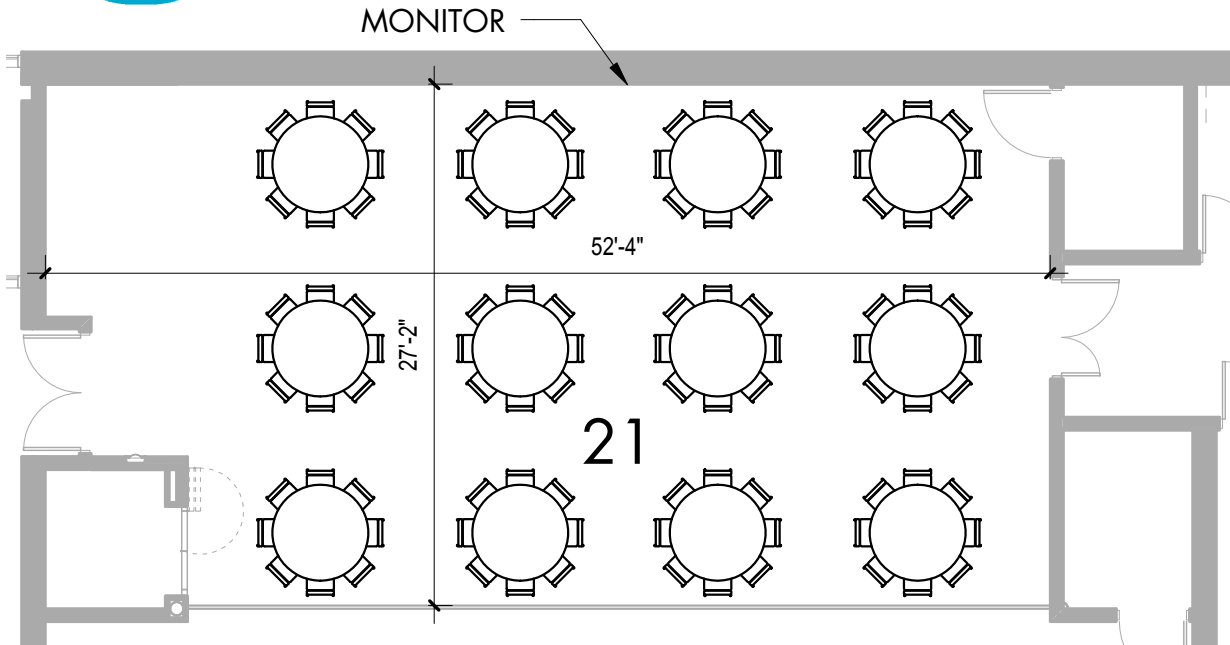

SAMPLE SET-UP

TABLES : 12

CHAIRS: 96

EQUIPMENT

MONITOR

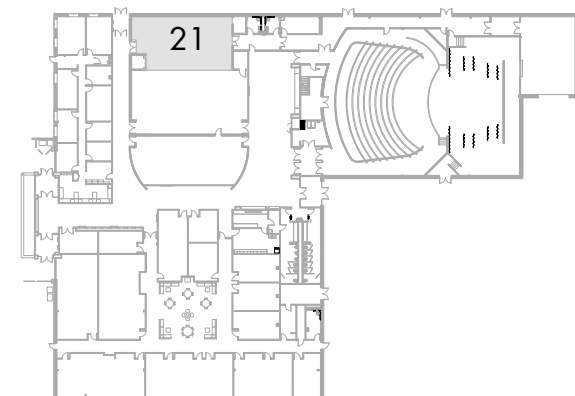

HOURLY ROOM RATES (MINIMUM OF 2 HOURS, HOLIDAYS BILLED AT A RATE OF TIME AND A HALF)

MONDAY-THURSDAY:	RESIDENT = \$75	NON-RESIDENT = \$95
FRIDAY-SUNDAY:	RESIDENT = \$95	NON-RESIDENT = \$120

WIRED MICROPHONE \$15 PER RENTAL (OPTIONAL)



COMMUNITY ARTS CENTER

at the Buffalo Grove Park District

FULL MPR 20|21

3335 SF

EVENTS:
WEDDINGS
SHOWERS
BAR | BAT MITZVAH
PARTIES

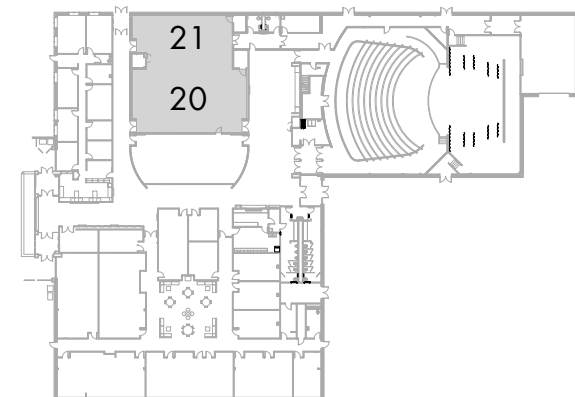

HOURLY ROOM RATES (MINIMUM OF 2 HOURS, HOLIDAYS BILLED AT A RATE OF TIME AND A HALF)

MONDAY-THURSDAY:	RESIDENT = \$100	NON-RESIDENT = \$125
FRIDAY-SUNDAY:	RESIDENT = \$125	NON-RESIDENT = \$160

CUSTODIAL FEE:	\$25 PER HOUR	(REQUIRED)
PROJECTOR AND SCREEN:	\$150 PER RENTAL	(OPTIONAL)
WIRED MICROPHONE:	\$15 PER RENTAL	(OPTIONAL)



COMMUNITY ARTS CENTER

at the Buffalo Grove Park District

FULL MPR 20|21

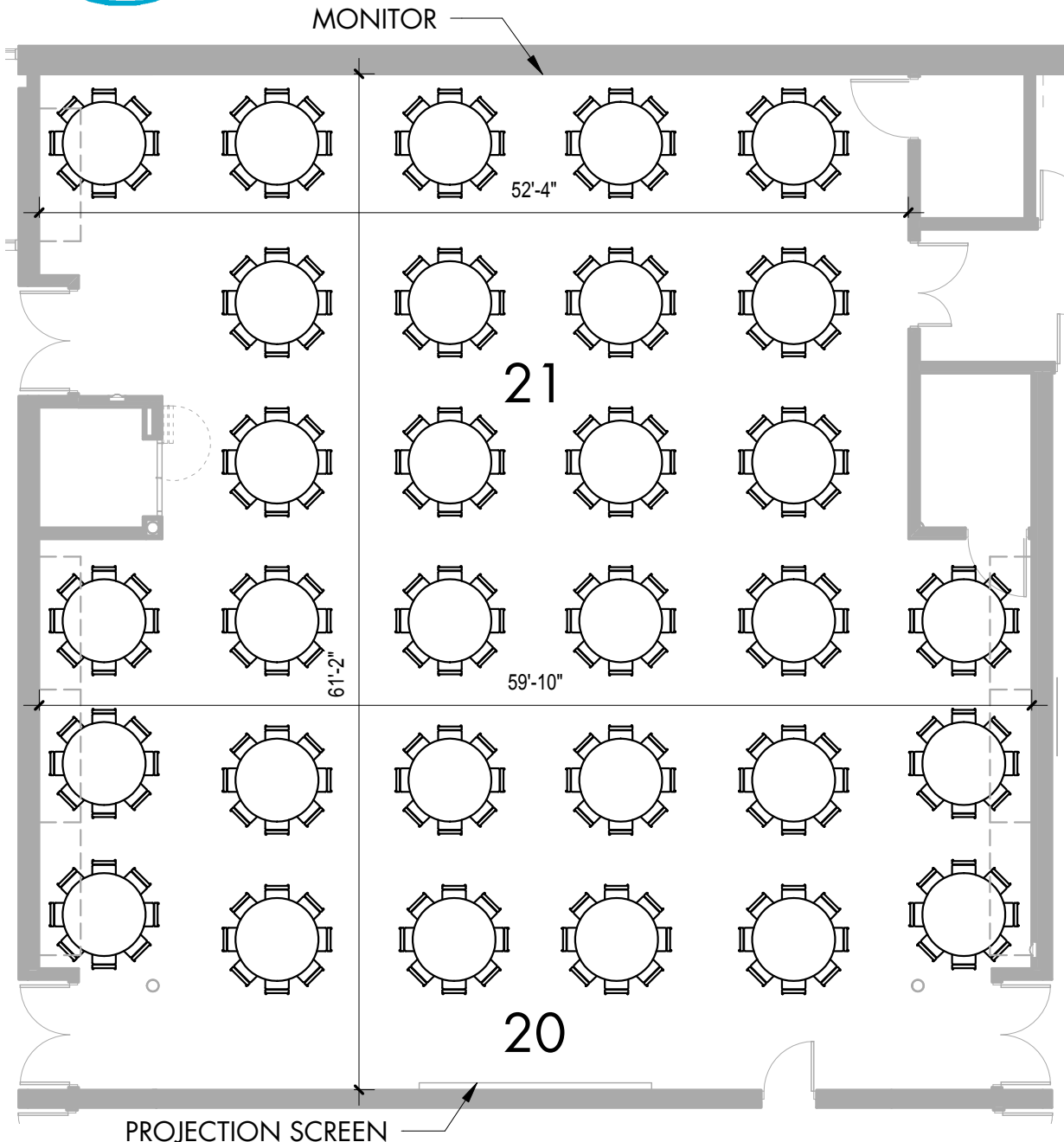

OPTION A

TABLES : 31

CHAIRS: 248

EQUIPMENT

PROJECTOR

SCREEN

MONITOR

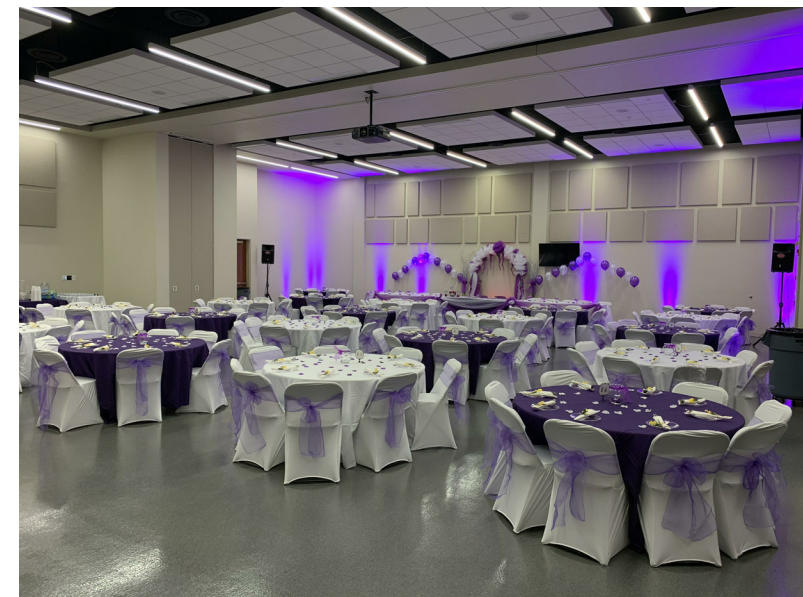



COMMUNITY ARTS CENTER

at the Buffalo Grove Park District

FULL MPR 20 | 21

OPTION B

TABLES : 10

CHAIRS: 80

EQUIPMENT

PROJECTOR

SCREEN

MONITOR

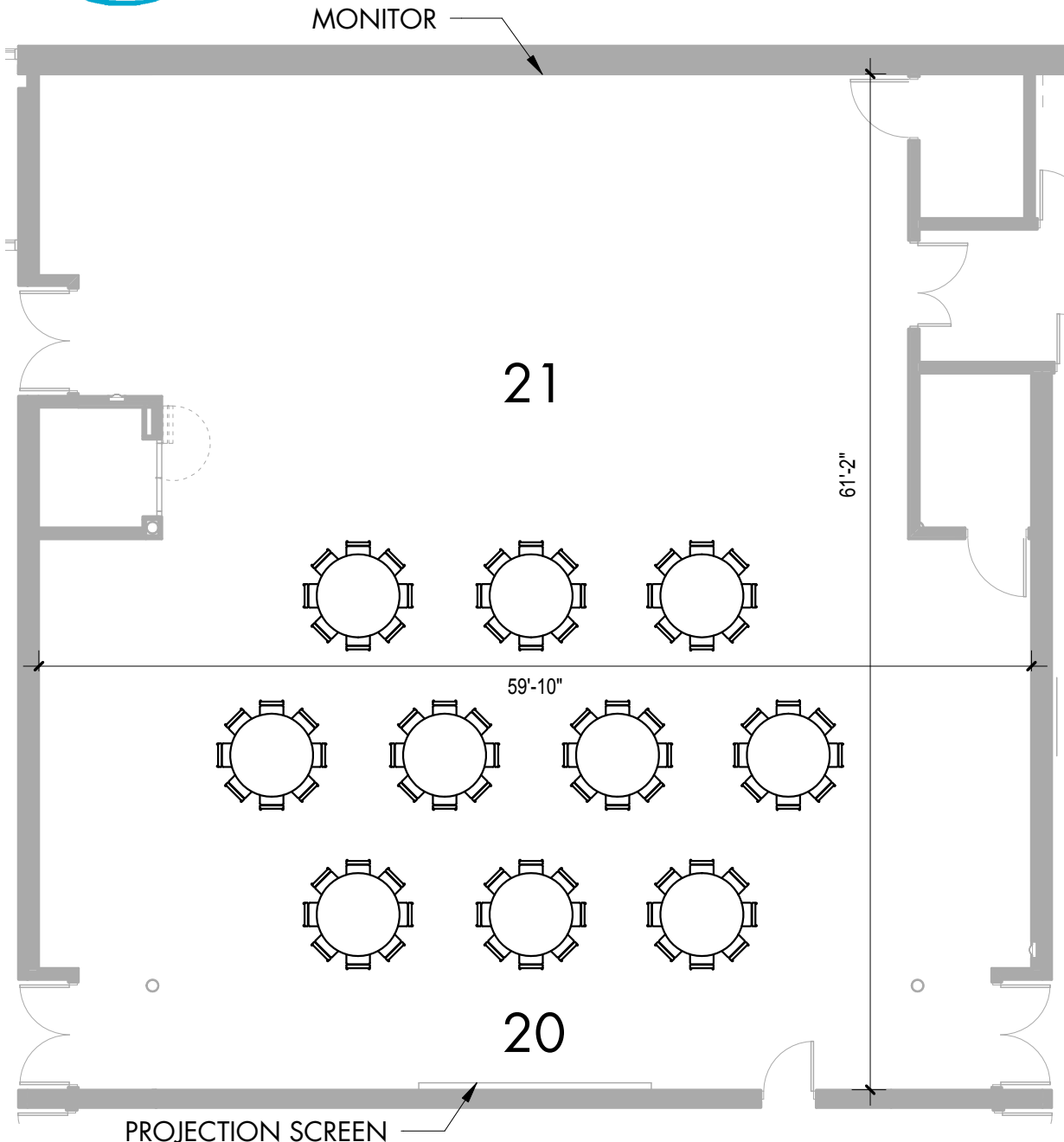



COMMUNITY ARTS CENTER

at the Buffalo Grove Park District

THEATER/STAGE

4305 SF - THEATER

1295 SF - STAGE

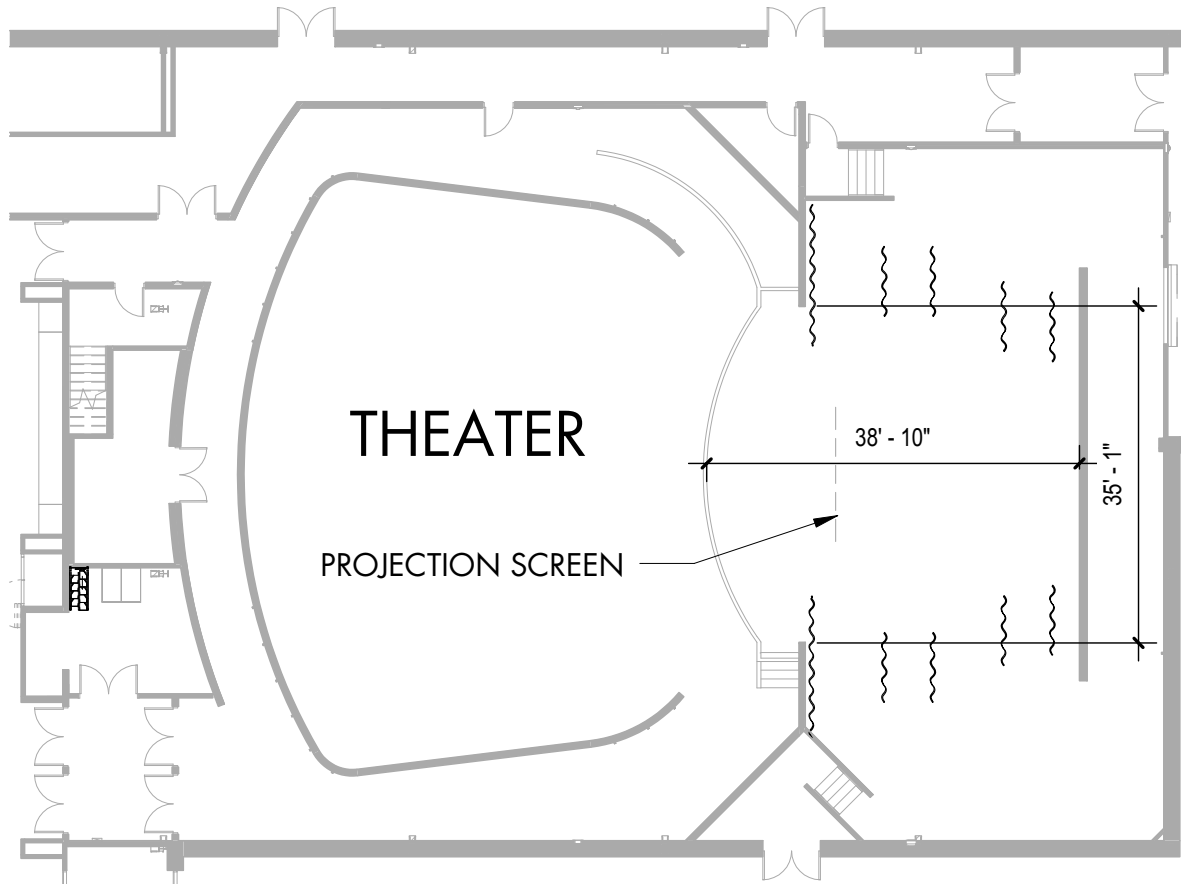

SAMPLE SET-UP

TABLES : 10

CHAIRS: 80

EQUIPMENT

PROJECTOR

SCREEN

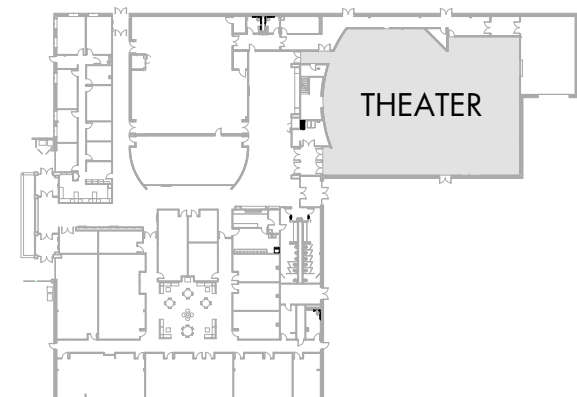

HOURLY ROOM RATES (MINIMUM OF 2 HOURS, HOLIDAYS BILLED AT A RATE OF TIME AND A HALF)

MONDAY-THURSDAY: RESIDENT = \$125 NON-RESIDENT = \$160

FRIDAY-SUNDAY: RESIDENT = \$155 NON-RESIDENT = \$195

CUSTODIAL FEE: \$25 PER HOUR (REQUIRED)